

ALT NO	AUTHY	DESCRIPTION	SME
⑤	(D)	15:210 FG-150 WAS	5/11/35

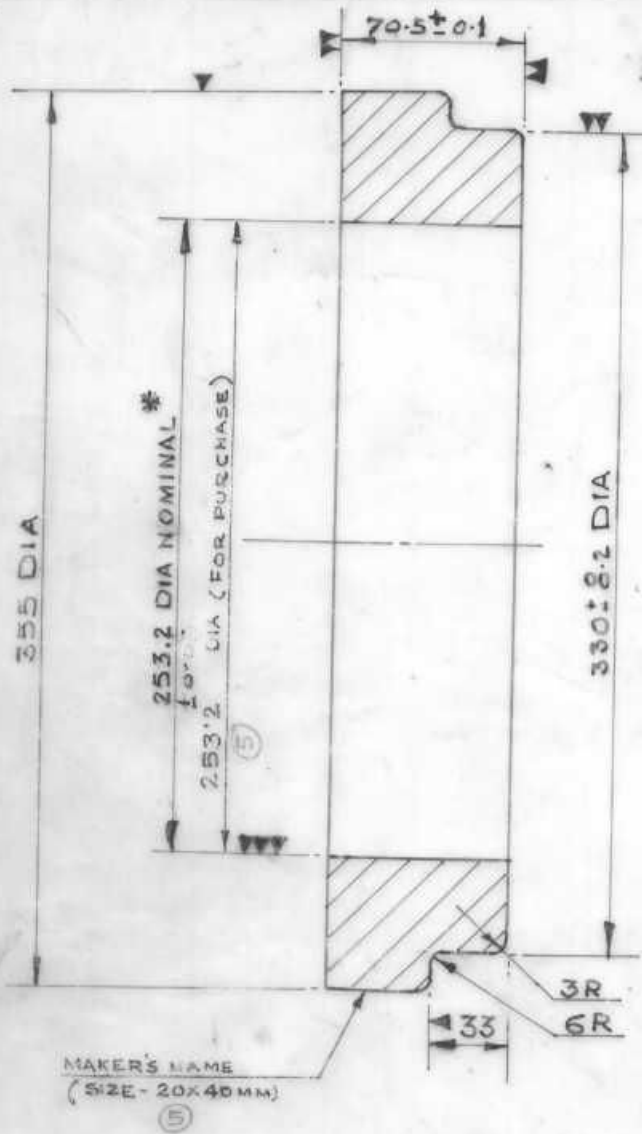

NOTE:-

1. THE BORE IS TO BE PROOF MACHINED TO 248 ± 0.4 DIA.
2. THE BORE IS TO BE FINISHED TO SUIT AXLE TO OBTAIN PRESS FIT WITH AN INTERFERENCE OF 0.051 TO 0.102 TO OBTAIN A PRESSURE OF 8 TO 10 TONNES, AT LEAST 10 DAYS AFTER PROOF MACHINING.
3. THIS DRG. SUPERSEDES DRG. NO. - 05/4/11/35.
4. CASTING SHALL BE SMOOTH & FREE FROM ANY CASTING DEFECTS.
5. MAKER'S NAME YEAR AND MONTH OF MANUFACTURE TO BE ETCHED IN POSITION AS SHOWN IN THE DRAWING.

C&D NO. FOR WAP-1 R202/07B

② C&D NO. FOR WCM/6 D202/004

⑥ 15:210
FG-150

NOTE: 1. 5 ADDED. FROM 15:210 TO 15:210 WAS	DRG. RETRACED & BROUGHT UP TO DATE	वर्षन DATED INITIAL SME/DI	REF No	वर्षन DESCRIPTION	संख्या NO/LOCO	पदार्थ MATL	विरचित SPECN	①
⑤	④	⑤	F202/054	AXLE COLLAR	6	CAST IRON	F202/GR-17/004	
वर्षन DRAWN	जांचा CHECKED	अधीनस्थ SUPOT	अनुमोदित DY OEE/DI	संदर्भ REF ASSLY DRG NO. 05/2/11/103 REF-6 03/2/11/47, REF-6 03/11/11/52, REF-6 ③	चित्ररजन रेल इंजन कारखाना CHITTARANJAN LOCOMOTIVE WORKS	प्रयोग में USE FOR LOCOS- WAG/5, WCM/6, WAG/7. ①	आरेखण संख्या DRAWING NO. 05/4/11/107	
परिचय संख्या ALT NO	वर्षन AUTHY	समूह GROUP NUMBER	संख्या NO	दिनांक DATE	चिह्न SYMBOL	स्केल SCALE - 1:2.5	परिचय संख्या	

