

- NOTE :-**
1. TO BE TESTED AS PER CLW TEST SPECN. No. CLW/TS/99-90/0014 DT. 11-06-08.
  2. CASTING TO BE CLEANED PROPERLY BOTH INSIDE & OUTSIDE.
  3. PLASTIC CAPS TO BE PROVIDED AT THE PIPE CONNECTIONS AFTER INSPECTION & TESTING. THE CAP SHOULD BEAR THE SIZE OF BSP THREADS MARKED ON THEM.
  4. EACH PIECE SHOULD BE EMBOSSED/ENGRAVED WITH MAKER'S NAME, MONTH, YEAR & BATCH No. OF MANUFACTURING AT CONSPICUOUS MANNER AND PLACE.
  5. THIS DRG. SUPERSEDES DRG. No. 0/3/65/56 ALT. ⑤
  6. THIS DRG. IS PREPARED BASED ON CLW DRG. No. 0/3/65/56, RDSO DRG. No. CG-K5031 & ELS/BZA DRG. No. B/TRS/Pn. EQPT/2/207.

- TECHNICAL DATA :-**
1. OPERATING PRESSURE : 10 kg/cm<sup>2</sup>
  2. PRESSURE DROP IN CLEAN CONDITIONS (INITIAL) MAX. : 0.1 kg/cm<sup>2</sup>
  3. FILTRATION CAPACITY : 50 MICRON
  4. TEMPERATURE SUITABLE UPTO : 200 °C
  5. MATERIAL : SINTERED BRONZE
  6. THE DETAILED CLEANING PROCESS IS MENTIONED IN RDSO Drg. No. CG-K5032 ALT. 1.
  7. POROSITY BY VOLUME : 35 - 50 %
  8. DENSITY : 4.5 - 6.5 gm/cc.

\* RUBBER IRS R-48-88, COMPOUND 'B' OF CLAUSE 5.2.4.1 - HARDNESS 60 ± 5 SHORE 'A'.

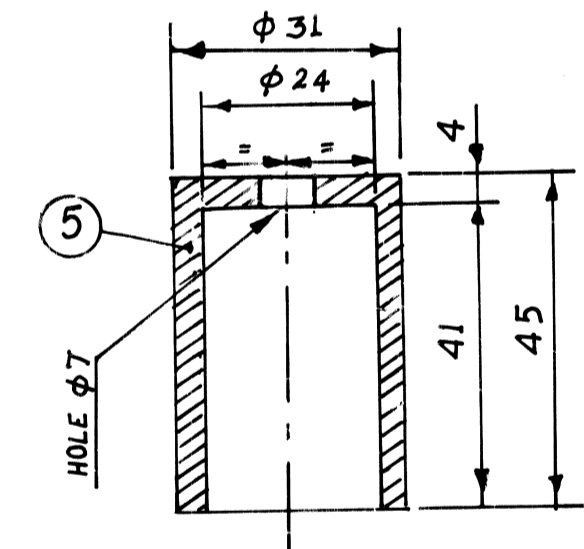
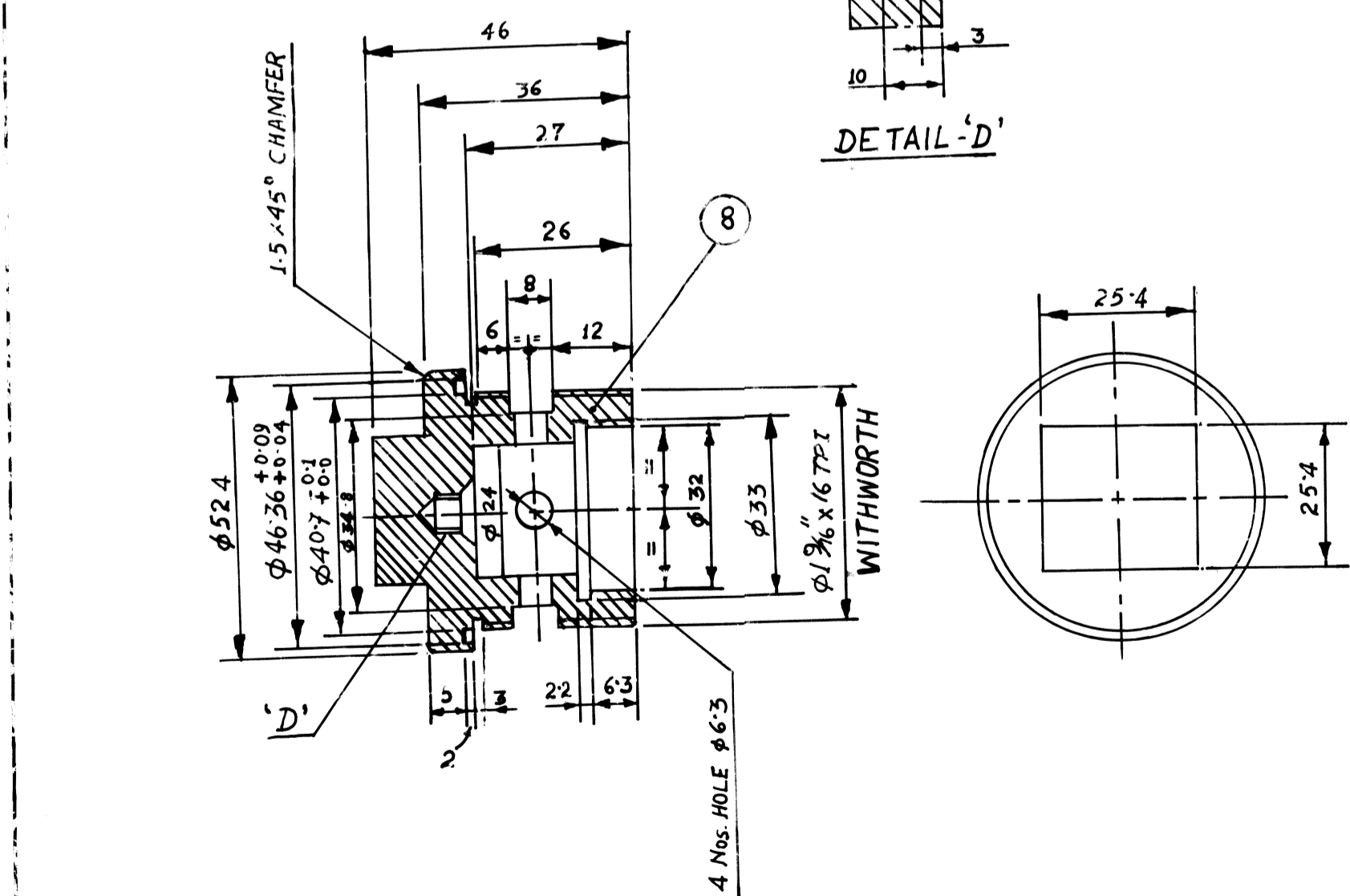

⊘ CHEMICAL COMPOSITION OF SINTERED BRONZE METALIC CAPSULE (REF-5) WITH IMPORTED GRANUALES :

| CONSTITUENTS              | PERCENT    |
|---------------------------|------------|
| COPPER                    | REMAINDER  |
| TIN                       | 9.5 - 11.5 |
| IRON, MAX                 | 1.0        |
| PHOSPHOROUS, MAX          | 0.5        |
| ACID INSOLUBLE, MAX       | 0.2        |
| TOTAL OTHER ELEMENTS, MAX | 0.5        |
| HYDROGEN LOSS, MAX        | 0.5        |

| NO. | DESCRIPTION                                     | MATERIAL | STANDARD           |
|-----|---|----------|--------------------|
| 8   | STRAINER CAP                                    | BRONZE   | IS-1458 CL-II      |
| 7   | GASKET - O/D 46.25 I/D 40.6 & THK. 3 ± 0.25     | RUBBER   | *                  |
| 6   | GASKET - O/D 32, I/D 24, 1.8 THK                | RUBBER   | *                  |
| 5   | SINTERED BRONZE FILTER ELEMENT                  | ⊘        | -                  |
| 4   | GASKET - O/D 12.5, I/D 6.5 & 1.5 THK            | RUBBER   | *                  |
| 3   | PLAIN WASHER SIZE - O/D 12.5 I/D 6.5 & 1.5 THK. | BRASS    | IS-319 GR II       |
| 2   | PAN HEAD SCREW SIZE M6X75 LONG TO IS:6101-82    | S. STEEL | ASTM A 240 Gr. 321 |
| 1   | BODY FOR STRAINER TYPE-T                        | C.I.     | IS:210 GR-20       |

| SIZE    | DESCRIPTION | C & D No.              | QTY/ C & D |
|---------|-------------|------------------------|------------|
| THD 'A' | 3/8" BSP    | P-315/316<br>R-315/137 | 4 Nos.     |
| THD 'B' | 1/2" BSP    | P-315/311<br>R-315/114 | 12 Nos.    |

| परिचय संख्या | आधिकार | वर्णन       | ड्राइंग      |
|--------------|--------|-------------|--------------|
| ALT. NO.     | AUTHY. | DESCRIPTION | DATE/INITIAL |
|              |        |             |              |

धातु वेल्डिंग विधि भा: मा: 813 के अनुसार/WELDING SYMBOL IS: 813

| संख्या | वर्णन       | संख्या | वर्णन       |
|--------|-------------|--------|-------------|
| NO.    | DESCRIPTION | NO.    | DESCRIPTION |
| 1      | 0.05        | 1      | 0.05        |
| 2      | 0.05        | 2      | 0.05        |
| 3      | 0.1         | 3      | 0.1         |
| 4      | 0.2         | 4      | 0.2         |
| 5      | 0.4         | 5      | 0.4         |
| 6      | 0.8         | 6      | 0.8         |
| 7      | 1.6         | 7      | 1.6         |
| 8      | 3.2         | 8      | 3.2         |
| 9      | 6.3         | 9      | 6.3         |
| 10     | 12          | 10     | 12          |
| 11     | 25          | 11     | 25          |
| 12     | 50          | 12     | 50          |

आदेश संख्या: 13.06.08

DATE: 13.06.08

BY: P. K. Pandit

CHECKED: [Signature]

SUPOT: [Signature]

REF. ASSLY USE NO.

WAP-4 & WAG-7

TYPE-T' FOR BRAKE EQUIPT.

0/2/65/440